

Grade 80 Toebehoren / Grade 80 Accessories

13. Inkort gaffelhaken met veiligheidspin / Clevis grab hooks with safety pin

14. Inkort gaffelhaken / Clevis grab hooks

15. Inkort ooghaken met veiligheidspin / Eye grab hooks with safety pin

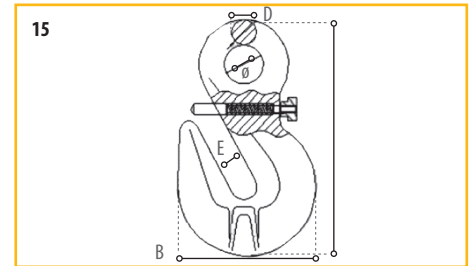
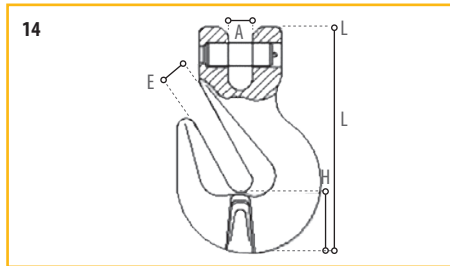
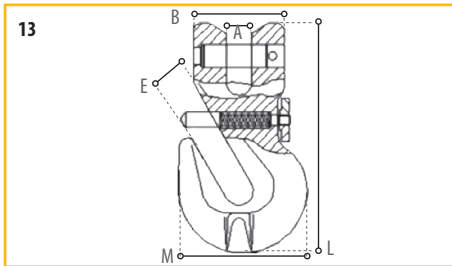

| 13 Inkort gaffelhaken met veiligheidspin / Clevis grab hooks with safety pin Afmetingen / Dimensions | | | | | | | | | |
|---|-----------|-------|-------|-------|--------|--------|-------------|--|--|
| Item no. | WLL (ton) | A | B | E | M | L | Weight (kg) | | |
| YE.8.042.06 | 1.12 | 8.00 | 32.00 | 8.00 | 43.50 | 75.00 | 0.28 | | |
| YE.8.042.08 | 2.00 | 9.50 | 35.00 | 11.00 | 49.50 | 89.00 | 0.33 | | |
| YE.8.042.10 | 3.15 | 12.50 | 42.50 | 13.20 | 70.50 | 126.50 | 0.88 | | |
| YE.8.042.13 | 5.30 | 15.00 | 53.00 | 16.50 | 90.00 | 163.50 | 1.85 | | |
| YE.8.042.16 | 8.00 | 19.50 | 65.50 | 19.20 | 112.50 | 183.50 | 3.24 | | |

| 14 Inkort gaffelhaken / Clevis grab hooks Afmetingen / Dimensions | | | | | | |
|--|-----------|-------|-------|-------|--------|-------------|
| Item no. | WLL (ton) | E | A | H | L | Weight (kg) |
| YE.8.042.20 | 12.50 | 24.00 | 24.00 | 56.00 | 219.00 | 5.00 |

| 15 Inkort ooghaken met veiligheidspin / Eye grab hooks with safety pin Afmetingen / Dimensions | | | | | | | |
|---|-----------|-------|-------|-------|-------|--------|-------------|
| Item no. | WLL (ton) | Ø | B | D | E | L | Weight (kg) |
| YE.8.041.08 | 2.00 | 17.00 | 50.00 | 9.50 | 11.00 | 88.50 | 0.29 |
| YE.9.041.10 | 3.15 | 20.00 | 71.00 | 13.00 | 13.00 | 121.50 | 0.75 |
| YE.8.041.13 | 5.30 | 26.00 | 96.00 | 16.50 | 16.50 | 158.00 | 1.62 |



Grade 80 Accessoires / Grade 80 Zubehör

13. Crochets à chape raccourcis avec linguet / Gabelkopfhaken mit Sicherheitsbolzen

14. Crochets à chape raccourcis / Gabelkopfhaken

15. Crochets à oeil raccourcis avec linguet / Ösenhaken mit Sicherheitsbolzen

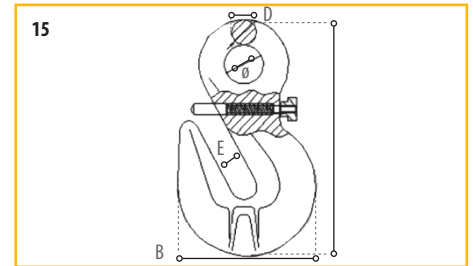
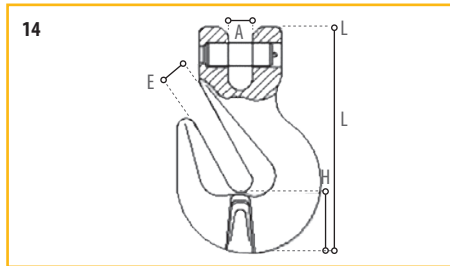
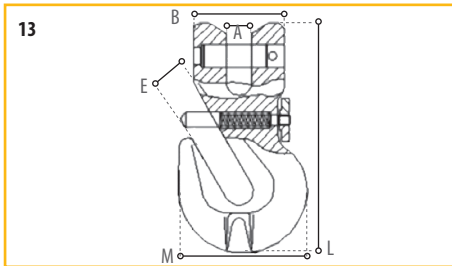

| 13 Crochets à chape raccourcis avec linguet / Gabelkopfhaken mit Sicherheitsbolzen Dimensions / Abmessungen (mm) | | | | | | | | |
|---|-----------|-------|-------|-------|--------|--------|-------------|--|
| Item no. | WLL (ton) | A | B | E | M | L | Weight (kg) | |
| YE.8.042.06 | 1.12 | 8.00 | 32.00 | 8.00 | 43.50 | 75.00 | 0.28 | |
| YE.8.042.08 | 2.00 | 9.50 | 35.00 | 11.00 | 49.50 | 89.00 | 0.33 | |
| YE.8.042.10 | 3.15 | 12.50 | 42.50 | 13.20 | 70.50 | 126.50 | 0.88 | |
| YE.8.042.13 | 5.30 | 15.00 | 53.00 | 16.50 | 90.00 | 163.50 | 1.85 | |
| YE.8.042.16 | 8.00 | 19.50 | 65.50 | 19.20 | 112.50 | 183.50 | 3.24 | |

| 14 Crochets à chape raccourcis / Gabelkopfhaken Dimensions / Abmessungen (mm) | | | | | | |
|--|-----------|-------|-------|-------|--------|-------------|
| Item no. | WLL (ton) | E | A | H | L | Weight (kg) |
| YE.8.042.20 | 12.50 | 24.00 | 24.00 | 56.00 | 219.00 | 5.00 |

| 15 Crochets à oeil raccourcis avec linguet / Ösenhaken mit Sicherheitsbolzen Dimensions / Abmessungen (mm) | | | | | | | |
|---|-----------|-------|-------|-------|-------|--------|-------------|
| Item no. | WLL (ton) | Ø | B | D | E | L | Weight (kg) |
| YE.8.041.08 | 2.00 | 17.00 | 50.00 | 9.50 | 11.00 | 88.50 | 0.29 |
| YE.9.041.10 | 3.15 | 20.00 | 71.00 | 13.00 | 13.00 | 121.50 | 0.75 |
| YE.8.041.13 | 5.30 | 26.00 | 96.00 | 16.50 | 16.50 | 158.00 | 1.62 |